

## HALF ROUNDS / MEZZO TONDO

### Type A

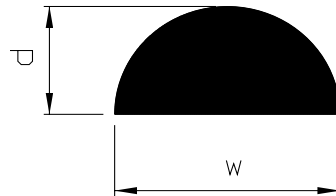

w	d	kg/m
12	6	0,90
16	8	1,60
20	10	2,50
25	12,5	3,90
30	15	5,65
40	20	10,0
50	25	15,7

### Type B

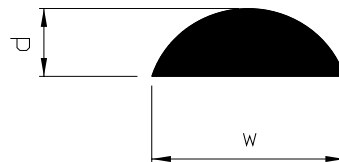

w	d	kg/m
10	3,5	
14	4	
15	5	
16	6	
18	5,3	
20	4	
20	6	
21,5	5,5	
25	7	
25	10	
30	10	
38	15	
50	12	