

HALF ROUNDS

Type A

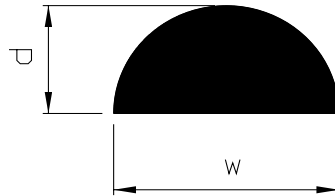

w	d	lbs/ft
.500	.250	0.30
.630	.315	0.52
.787	.393	0.83
1.000	.500	1.30
1.200	.600	1.86
1.260	.630	2.14
1.575	.787	3.33
1.772	.886	4.21
2.000	.500	5.21
2.362	1.181	7.50

Type B

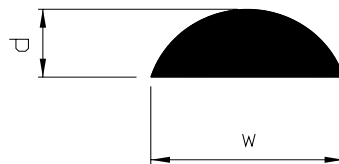

w	d	lbs/ft
.393	.138	0.13
.551	.157	0.21
.630	.236	0.37
.787	.157	0.29
.787	.236	0.45
1.181	.394	1.15
1.574	.394	1.48
2.000	.500	2.22